

MB600-2 Blast Pots



Product Features

MB Series Blast Pots are available in multiple configurations and specifications to suit varying market requirements worldwide. The MB600-2 is a large-capacity, automatic blast pot, suitable for low pressure blasting applications.

- ▶ Designed and manufactured in accordance with international standards and requirements.
- ▶ Third party pressure vessel certificates available on request.
- ▶ Tandem Remote Air Inlet and Manual Exhaust Valve, for fast and efficient operation.
- ▶ AirStop non-bleed type pneumatic deadman handle.
- ▶ PanBlast™ Corsa II abrasive control valve provides precise control and immediate shut off.
- ▶ Optional abrasive cut off for compressed air blow down.
- ▶ 60° pot shell cone, for improved abrasive flow. Wide, pneumatic wheels.
- ▶ Moisture trap, exhaust muffler and main air isolation valves standard.
- ▶ The low pressure pop up valve is not optional, it is standard on this model blast pot.
- ▶ 170 liters (6ft³) abrasive capacity, 120psi pressure rating.
- ▶ 32mm (1-1/4") fittings.

Common Applications

- ▶ Blasting with plastic media, baking soda and other light density abrasives.
- ▶ Shot peening applications.
- ▶ Blasting with very fine abrasives.
- ▶ Low pressure blasting to prevent substrate damage.

Complementary Products



Blast Hoses



Titan II SAR



Couplings & Nozzle Holders



Whip Checks



ATN Blast Nozzles



VisiFlo Premium



Electric Remote Conversion Kit



Blasting Suit & Gloves

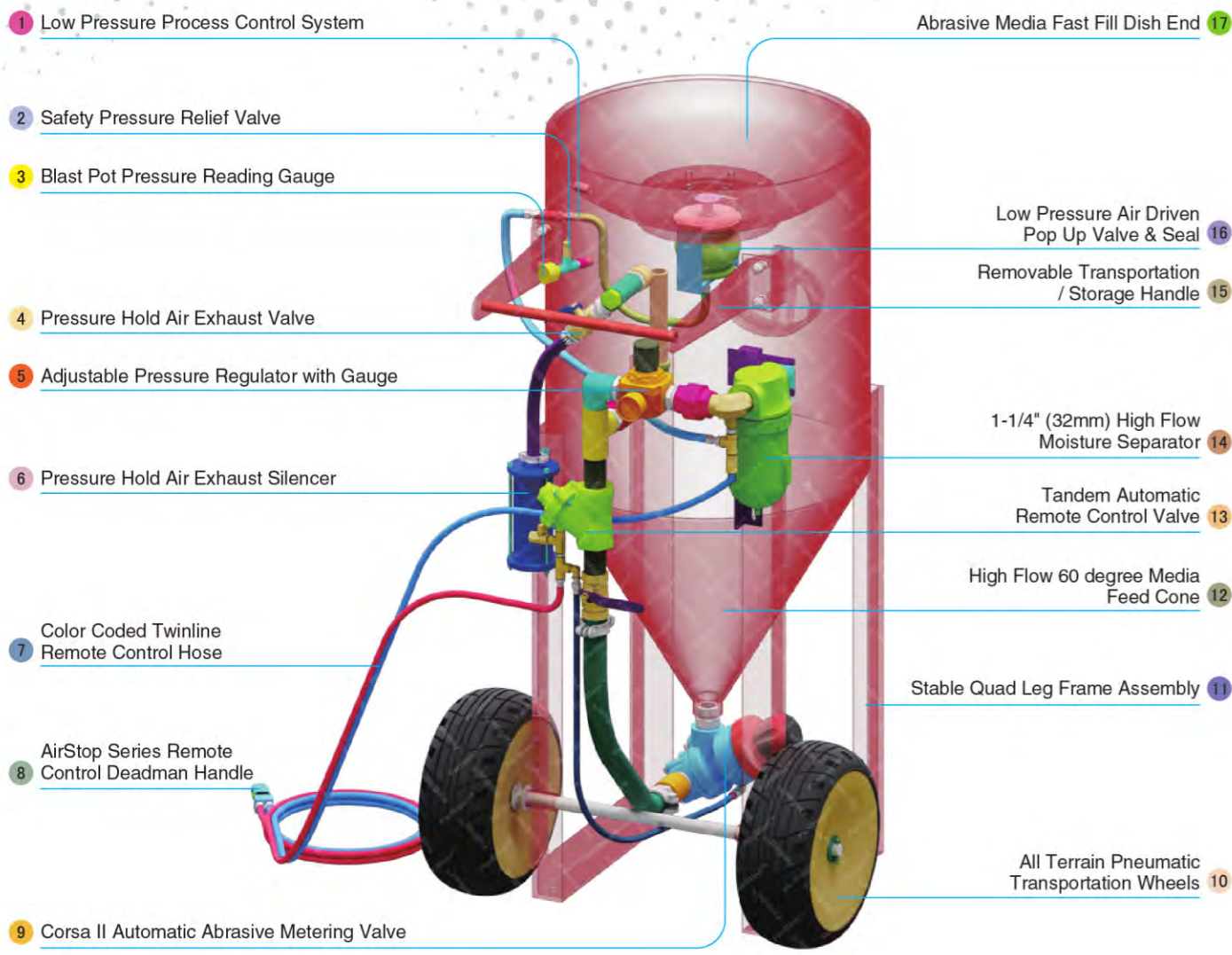
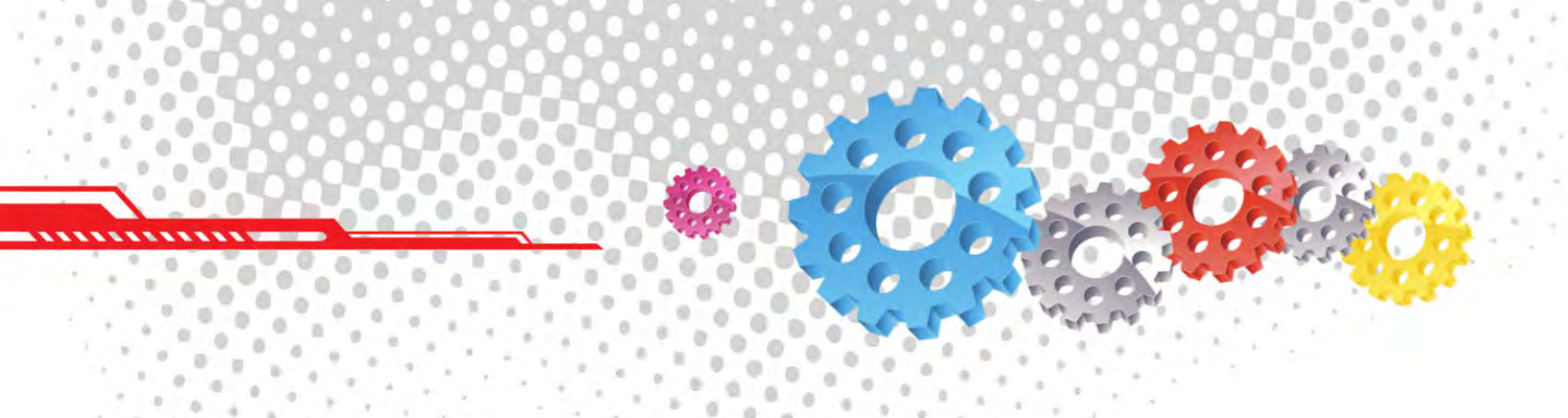

1 Low Pressure Process Control System

Abrasive Media Fast Fill Dish End 17

2 Safety Pressure Relief Valve

3 Blast Pot Pressure Reading Gauge

Low Pressure Air Driven Pop Up Valve & Seal 16

4 Pressure Hold Air Exhaust Valve

Removable Transportation / Storage Handle 15

5 Adjustable Pressure Regulator with Gauge

1-1/4" (32mm) High Flow Moisture Separator 14

6 Pressure Hold Air Exhaust Silencer

Tandem Automatic Remote Control Valve 13

7 Color Coded Twinline Remote Control Hose

High Flow 60 degree Media Feed Cone 12

8 AirStop Series Remote Control Deadman Handle

Stable Quad Leg Frame Assembly 11

9 Corsa II Automatic Abrasive Metering Valve

All Terrain Pneumatic Transportation Wheels 10

Component Highlights

- | | | |
|--|--|--|
| 1 Low Pressure Process Control System | 7 Color Coded Twinline Remote Control Hose | 13 Tandem Automatic Remote Control Valve |
| 2 Safety Pressure Relief Valve | 8 AirStop Series Remote Control Deadman Handle | 14 1-1/4" (32mm) High Flow Moisture Separator |
| 3 Blast Pot Pressure Reading Gauge | 9 Corsa II Automatic Abrasive Metering Valve | 15 Removable Transportation / Storage Handle |
| 4 Pressure Hold Air Exhaust Valve | 10 All Terrain Pneumatic Transportation Wheels | 16 Low Pressure Air Driven Pop Up Valve & Seal |
| 5 Adjustable Pressure Regulator with Gauge | 11 Stable Quad Leg Frame Assembly | 17 Abrasive Media Fast Fill Dish End |
| 6 Pressure Hold Air Exhaust Silencer | 12 High Flow 60 degree Media Feed Cone | |

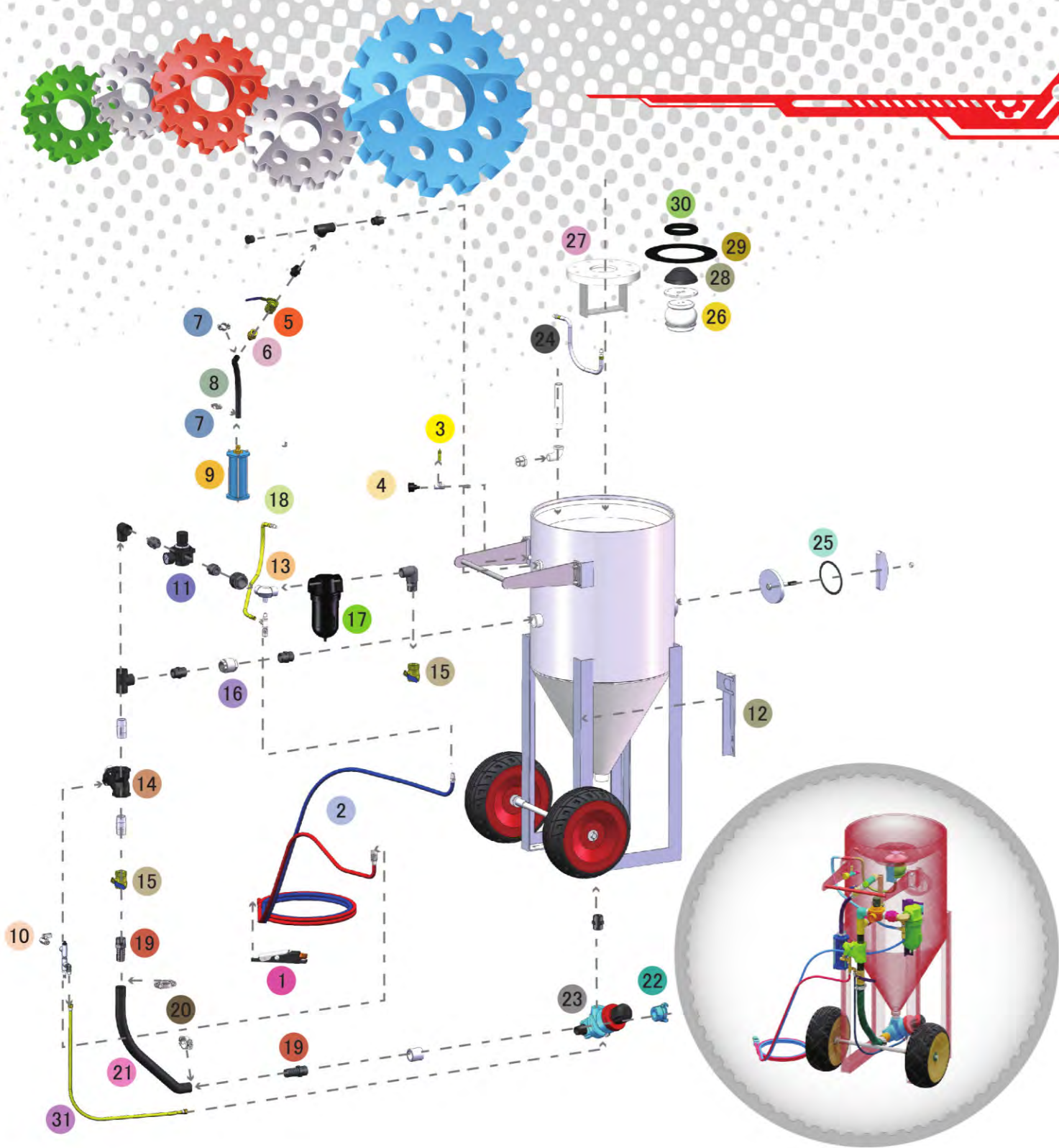

Assembly

Stock Code	Description	Dry Weight	Abrasive Capacity	Piping Size
BEP-PS-0022-00	MB600-2/BS Tandem Corsa II-US Airstop	245kg (540lbs)	170 litres (6ft ³)	32mm (1-1/4")



All data and information subject to change without prior notice. Brochure reference CAT-0103-02-00



Parts List



Description	Qty	Description	Qty	Description	Qty
1 Airstop Pneumatic Control Handle	1	12 Support Bracket	1	23 Corsa II 1-1/4" With Urethane Sleeve	1
2 20m (66') Twinline Hose Assembly	1	13 Elbow	1	24 Connecting Hose	1
3 1/2" BSP-125 PSI Pressure Relief Valve	1	14 1 1/4" Tandem NPT Valve Assembly	1	25 Blast Pot-H/Hole 192x144 -Sealing Gasket	1
4 6mm (1/4") Pressure Gauge - Rear Entry	1	15 32mm (1-1/4") Ball Valve	2	26 Air Spring	1
5 25mm (1") Ball Valve	1	16 32mm (1-1/4") Non Return Valve	1	27 Flanged Bracket	1
6 Hose Barb	1	17 32mm (1-1/4") Filter Separator	1	28 Pop-Up Valve	1
7 Hose Clamp	2	18 Connecting Hose	1	29 Gasket	1
8 Blast Hose 19mm x 34mm x 20m L2	0.4M	19 KC Nipple	2	30 Pop Up Valve Seating Ring	1
9 Exhaust Muffler	1	20 Hose Clamp	2	31 Connecting Hose	1
10 Mini Ball Valve	1	21 Hose-Air/Water Deliver 32mmIDx45mmOD	0.7M		
11 25mm(1") Pressure Regulator	1	22 NTC-1 Nylon Threaded Pot Coupling	1		